



Visitor Guide

Discover the Stanley A. Milner Library!

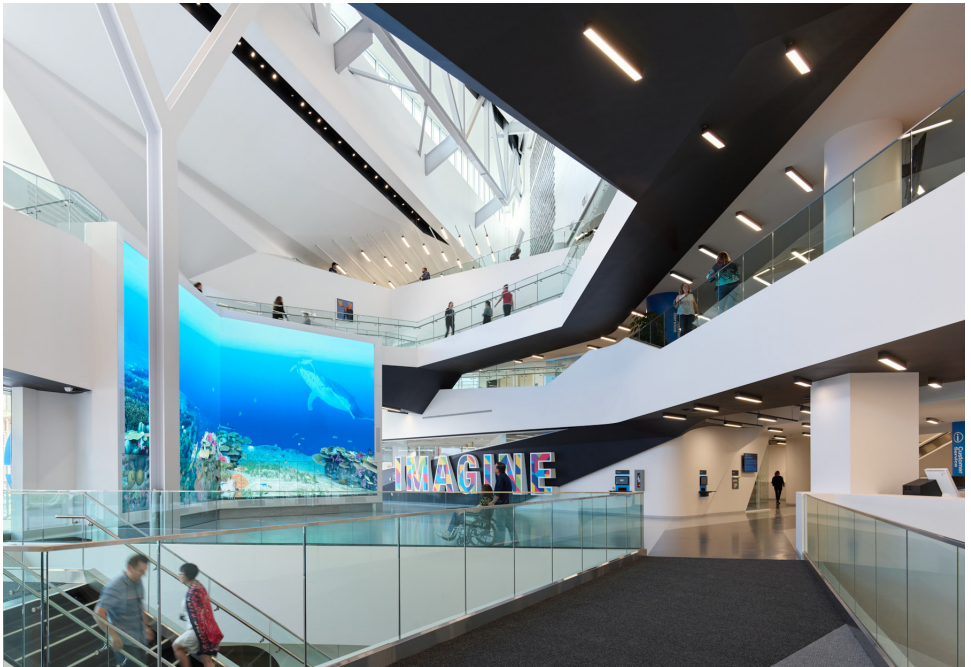

Photo credit: Andrew Latreille, Teeple Architects.



Welcome to the awesome world of Stanley A. Milner Library!

We hope you enjoy your time in this beautiful, reimagined space, nestled in the heart of downtown, that is free and open to all.

Before you begin...

We know. There is a lot to see. But as you take it all in, make sure you don't miss out on the following unique aspects of the library, that we are particularly excited to show you:

- Shelley Milner Children's Library with an indoor play area and Children's Makerspace.
- A 10,000 square foot Makerspace for grown-ups – kids shouldn't have all the fun!
- Our multi-story interactive digital wall – dinos and insects and sharks, oh my!
- PĪYĒSĪW WĀSKĀHIKAN (Thunderbird House), an Indigenous space for gathering and ceremonies.

Play and Learn

Be prepared to be amazed. The Shelley Milner Children's Library is every kid's dream come true. And the Children's Makerspace is a parent's dream come true because we clean up the mess!

We encourage you to explore this magical space, the giant floor piano, the fun classes, the videogames and the mountains of stories that will take you on countless adventures.

Create and Explore

Uncover cutting-edge technologies at the Makerspace and Fab Lab on the second floor. Dive into our state-of-the-art sound and video production suites or if you're feeling culinary, try out a new recipe in The Kitchen.

Art and Culture

Need a dose of culture? Hit up the Muttart Theatre on the lower floor for some seriously captivating events. You can also immerse yourself in the vibrant world of Capital City Art as you explore the community art galleries scattered throughout the library.

Experience

At this point, you'll need a good place to relax. Head to the Civic Corner on the third floor and you'll find expansive skylights that open to breathtaking views giving you a serene escape in this welcoming ambiance.

Take a Self-Guided Tour

Want to choose your own adventure? Take a self-guided tour and let our awesome EPL staff be your virtual guides. Just follow the maps and listen to the headphone icons with numbers in this guide – it's your ticket to exploring at your own speed. We can't wait for you to dive into the endless possibilities to learn, explore and experience! Download the recorded tour at epl.ca/HelloMilner.

MAPS

BASEMENT

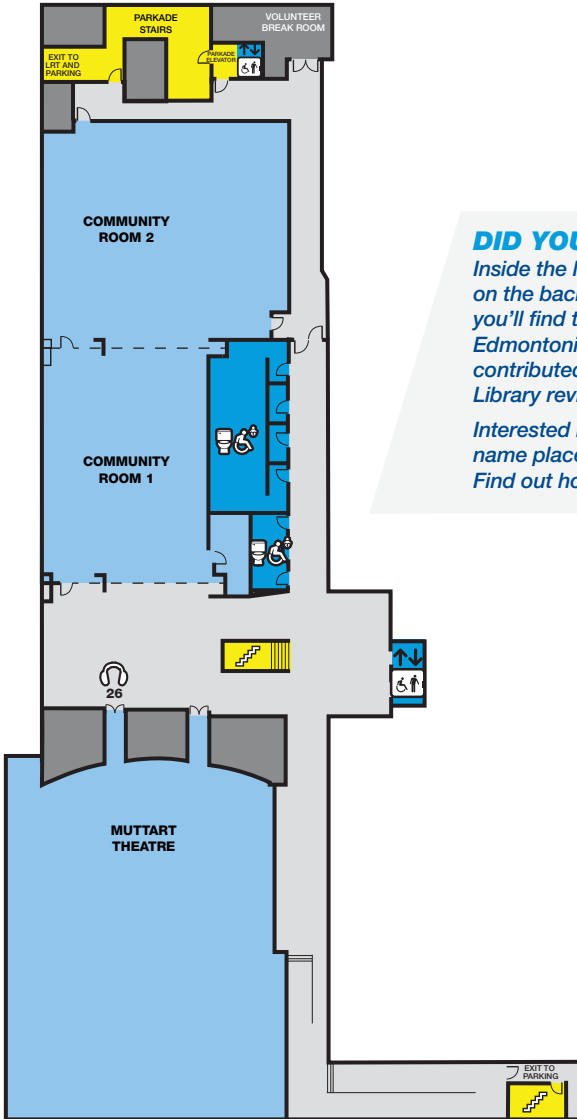

DID YOU KNOW?

Inside the Muttart Theatre on the back of some seats, you'll find the names of Edmontonians who have contributed to the Milner Library revitalization project.

Interested in having your name placed on a seat? Find out how at epl.ca/give.

Map Legend

- Stairs
- Elevator
- Universal Washroom
- Audio Tour

LEVEL 1



DID YOU KNOW?

The Shelley Milner Children's Library has over 100 robots, 25,000 LEGO pieces and 17,000 items in our collection!

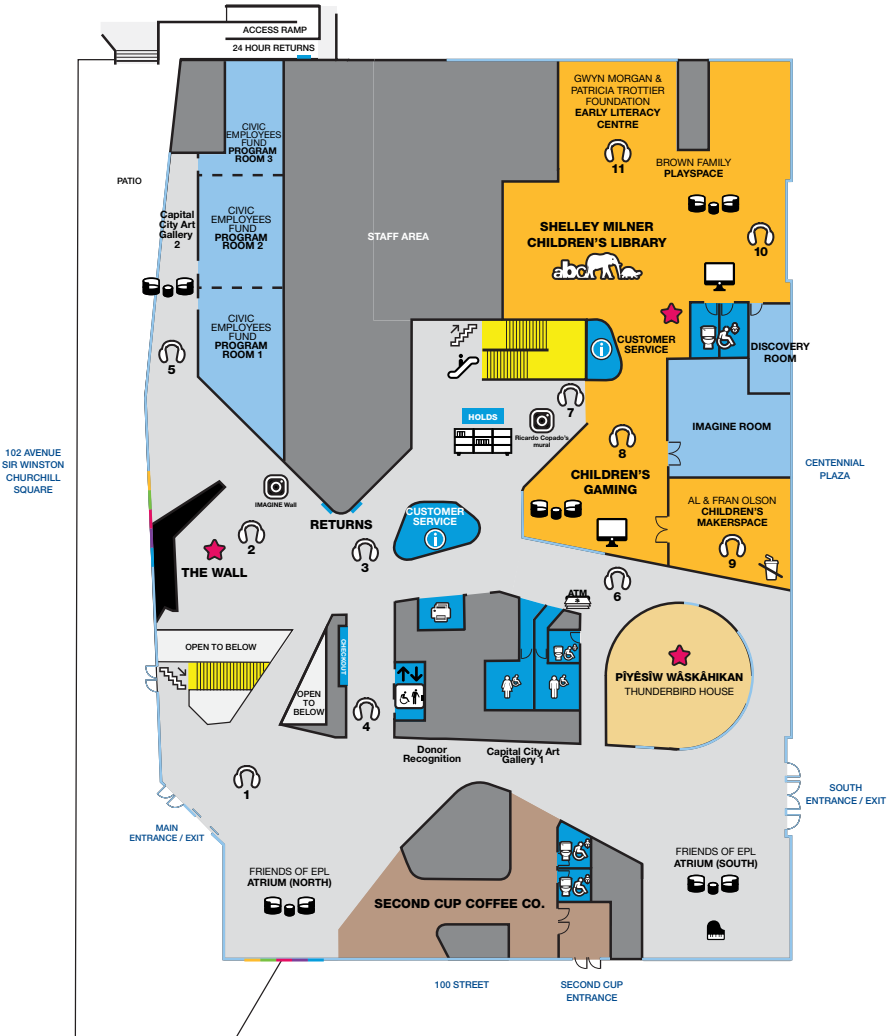

Map Legend

- Key Building Feature
- Elevator
- Universal Washroom
- No Snacks Allowed
- #instagrammable
- Escalator
- Women's Washroom
- Men's Washroom
- Stairs
- Audio Tour

LEVEL 2

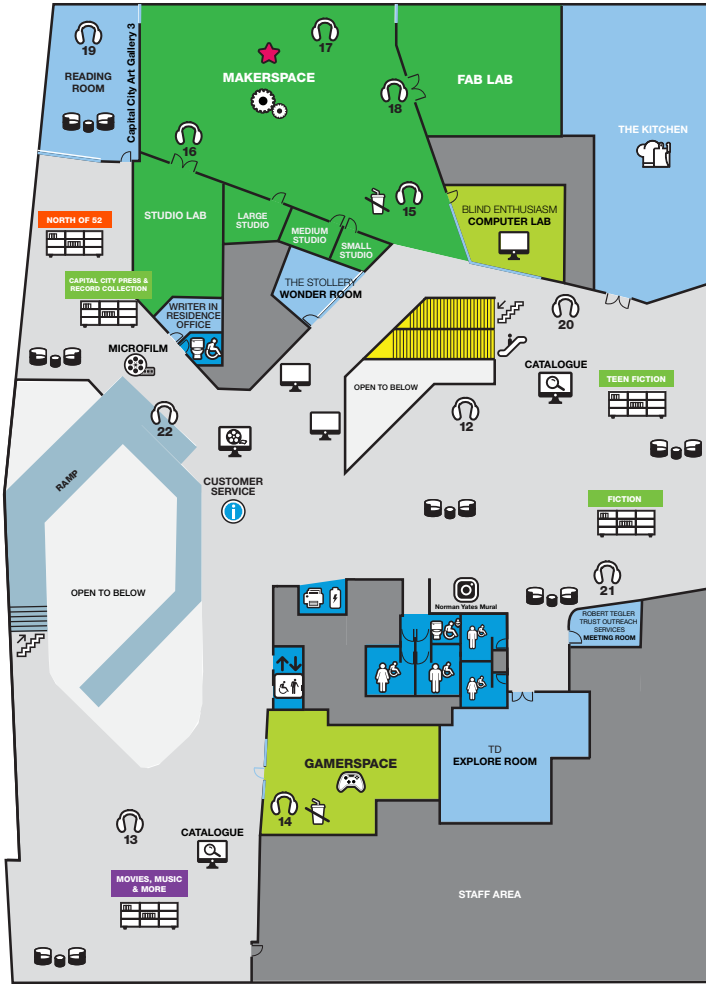

100 STREET

DID YOU KNOW?

Our Makerspace is over 10,000 square feet. There's so much to make and explore!

Map Legend

- | | | | |
|----------------------|-----------|--------------------|-------------------|
| Key Building Feature | Stairs | Audio Tour | Men's Washroom |
| Printer/Copier | Elevator | Universal Washroom | No Snacks Allowed |
| #instagrammable | Escalator | Women's Washroom | Charging Station |

LEVEL 3

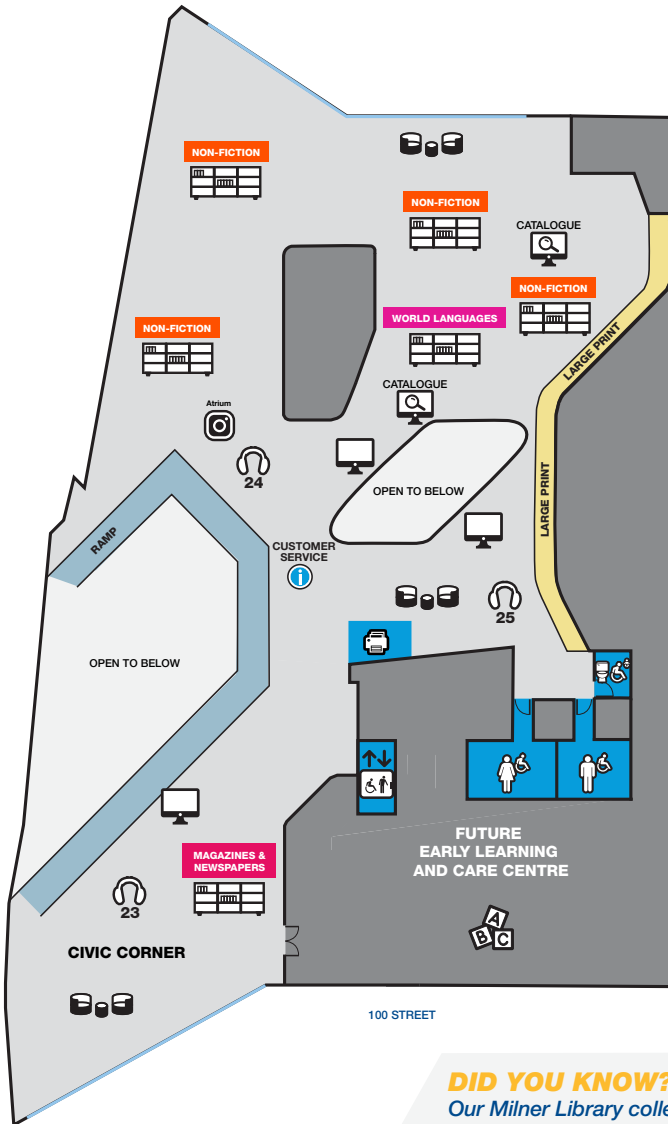

DID YOU KNOW?

Our Milner Library collection is over 150,000 items!

Map Legend

-  Printer/Copier
-  Elevator
-  Universal Washroom
-  Men's Washroom
-  #instagrammable
-  Audio Tour
-  Women's Washroom

LEVEL 6

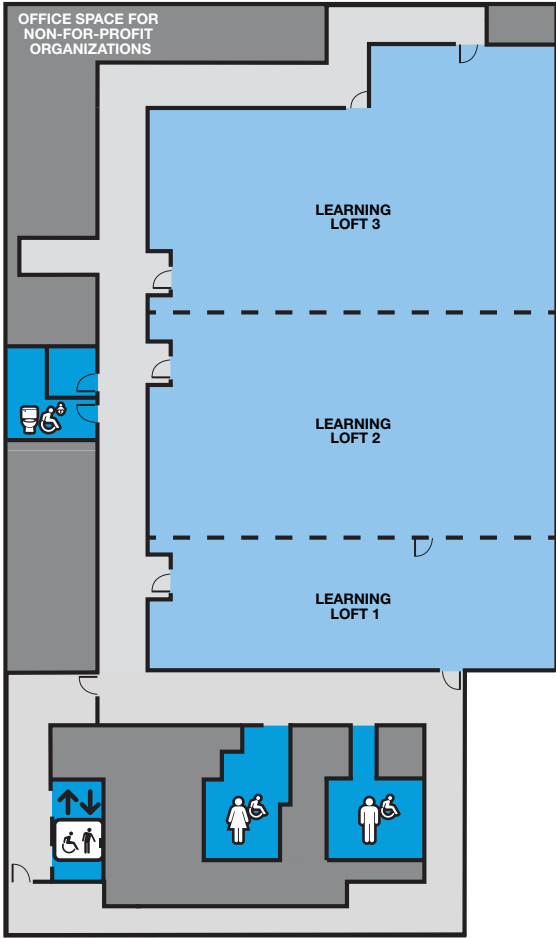

Map Legend

- Printer/Copier
- Women's Washroom
- Elevator
- Men's Washroom

DID YOU KNOW?

The Milner Library has over 28,000 square feet of meeting spaces! Book a meeting room with us!

VISIT US

7 Sir Winston Churchill Square

BRANCH HOURS:

Monday to Friday: 9 a.m. – 9 p.m.

Saturday: 9 a.m. – 6 p.m.

Sunday: 10 a.m. – 5 p.m.

Hours subject to change.

Visit epl.ca/hours for more information.

MEMBERSHIP

GET A FREE LIBRARY CARD

Did you know EPL is the largest lender of information and entertainment in town? Access physical and digital items like books, movies, music and magazines, attend classes and events in-branch or online, hop on a public computer, access fax and printing or get creative with our 3D printer, sound recording studios and more — all for FREE!

Visit a Customer Service Desk or epl.ca/signup today to get a card.

[epl.ca/HelloMilner](https://epl.ca>HelloMilner)



January 2024
Marketing and Communications
374244