

Boardroom style
Maximum 30 people

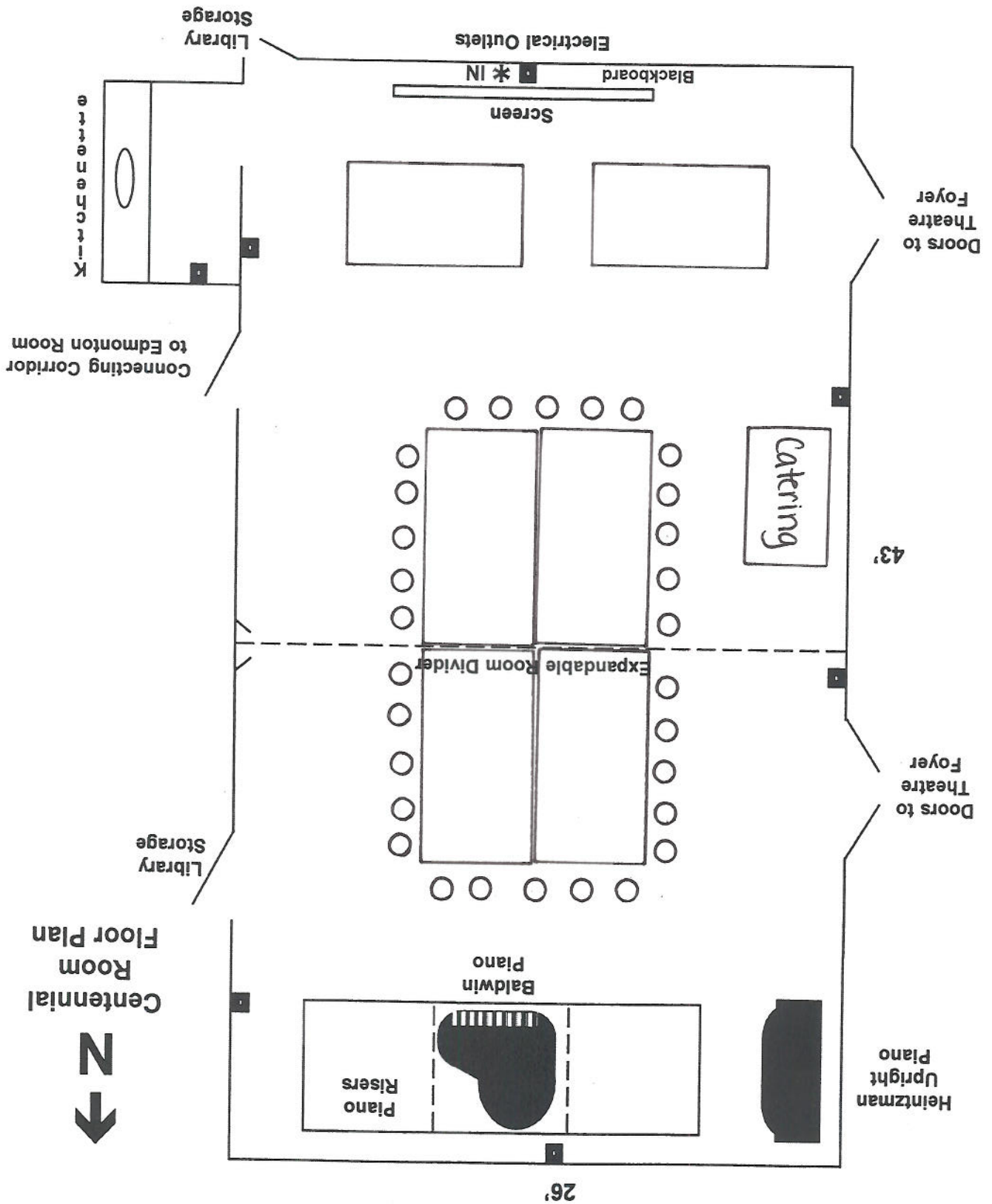

Centennial Room

Centennial Room Floor Plan



Connecting Corridor to Edmonton Room

Library Storage

Library Storage

Electrical Outlets

Blackboard

* IN

Screen

Doors to Theatre Foyer

Catering

43'

Doors to Theatre Foyer

Heintzman Upright Piano

Baldwin Piano

Piano Risers

26'

Expandable Room Divider